

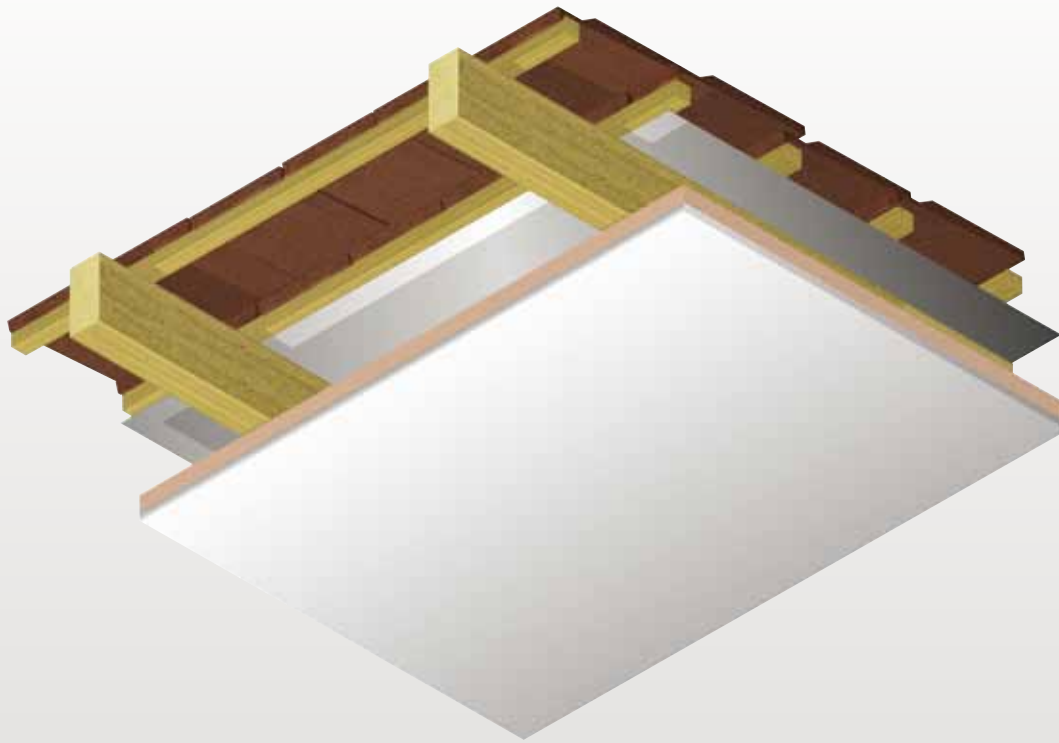

Kooltherm® K18 Insulated Plasterboard

INSULATED DRY-LINING PLASTERBOARD FOR MECHANICAL FIXING



- Super high performance rigid thermoset insulation
- Fibre-free insulation core
- 3-in-1 insulation, dry-lining and vapour control
- Group 1 BCA fire classification
- Allows quick response heating and cooling
- Clear cavity is maintained - resists moisture penetration
- Resistant to the passage of water vapour
- Easy to handle and install
- Ideal for new build and refurbishment
- CFC/HCFC-free with zero Ozone Depletion Potential (ODP)
- Compliant with AS/NZS 4859.1:2002



Low Energy –
Low Carbon Buildings

Typical Constructions and Total R-values

Mechanically fixed to timber rafters
(covered beams)

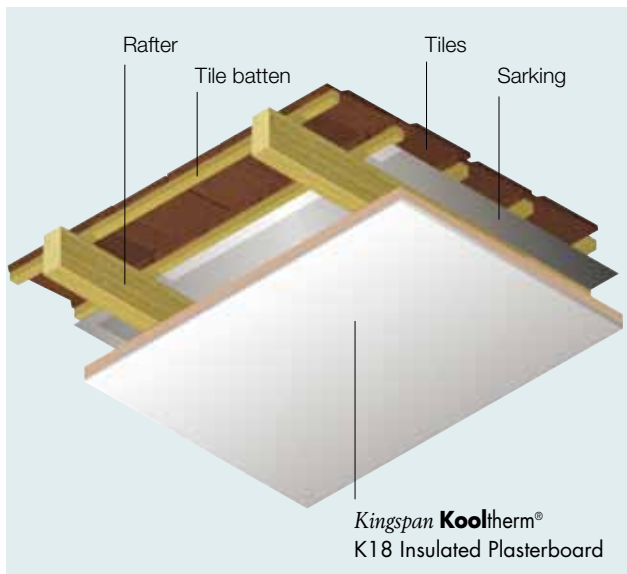

Figure 1

Total R-values for various product thicknesses of <i>Kingspan Kooltherm</i> [®] K18 Insulated Plasterboard		
Product thickness (mm)	Heat flow in	Heat flow out
35	R _T 2.3	R _T 2.0
40	R _T 2.6	R _T 2.2
50	R _T 3.1	R _T 2.7
60	R _T 3.7	R _T 3.3
70	R _T 4.2	R _T 3.8
80	R _T 4.7	R _T 4.3
90	R _T 5.2	R _T 4.8

Assumptions

The R-values shown are Total R-values for the building element and are calculated in accordance with AS/NZS 4859.1:2002 - Amdt 1 and NZS 4214:2006. *Kingspan Kooltherm*[®] products are manufactured, tested and packaged in conformance with AS/NZS 4859.1:2002 - Amdt 1.

The contribution of the product Total R-values depends on installation and environmental conditions. The R-value will be reduced in the event of the accumulation of dust on the upward facing surfaces and in those cavities that are ventilated.

Product Details

Product Description

Kingspan Kooltherm® K18 Insulated Plasterboard is a super high performance, fibre-free rigid thermoset insulation, sandwiched between a front facing of tapered edge gypsum based plasterboard, and a reverse facing of low emissivity foil autohesively bonded to the insulation core during manufacture.

Kingspan Kooltherm® K18 Insulated Plasterboard is manufactured without the use of CFCs/HCFCs and has zero Ozone Depletion Potential (ODP).



Product Data	
Thermal Conductivity (λ -value)*	0.020 W/m-K (Product thickness \geq 45 mm) 0.021 W/m-K (Product thickness 25 - 44 mm)
Emittance (Foil Face)	E0.14
Board Dimensions	2400 mm x 1200 mm (2.88 m ²)
Product Thickness (inc. Plasterboard)	35, 40, 50, 60, 70, 80, 90 mm
Plasterboard Thickness	10 mm

* The λ -values and R-values detailed are quoted in accordance with BS / I.S. EN 13166:2008 (Thermal insulation products for buildings – Factory made products of phenolic foam (PF) – Specification). Comparison with alternative products may not be appropriate unless the same procedures have been followed.

Product R-value

Product Thickness (inc. Plasterboard)	Product R-value
35 mm	R1.25
40 mm	R1.45
50 mm	R1.95
60 mm	R2.55
70 mm	R3.05
80 mm	R3.55
90 mm	R4.05

* R-values are calculated for each component and added together. The sum is rounded down to the nearest 0.05 (m²-K/W).



Figure 2 Super high performance Kingspan Kooltherm® K18 Insulated Plasterboard

Specification Guide

Kingspan Kooltherm® K18 Insulated Plasterboard

The wall dry-lining insulation shall be **Kingspan Kooltherm® K18 Insulated Plasterboard** comprising a 10 mm plasterboard facing bonded to ___ mm thick CFC/HCFC-free and zero Ozone Depletion Potential (ODP) rigid thermoset insulation manufactured under a management system certified to BS / I.S. EN ISO 9001:2008, BS / I.S. EN ISO 14001:2004 and BS / I.S. OHSAS 18001:2007 by Kingspan Insulation Pty Limited and shall be installed in accordance with the instructions issued by them.

Standards and Approvals

Kingspan Kooltherm® K18 Insulated Plasterboard is manufactured to the highest standards and certified under the following management systems:

Standard	Management System
BS / I.S. EN ISO 9001:2008	Quality Management
BS / I.S. EN ISO 14001:2004	Environmental Management
BS / I.S. OHSAS 18001:2007	Health and Safety Management

Product Testing

Characteristic	Test Method	Result
Thermal Conductivity (λ -value)	BS EN 13166:2008	0.020 W/m-K (Product thickness \geq 45 mm) 0.021 W/m-K (Product thickness 25 - 44 mm)
Compressive Strength	BS / I.S. EN 826:1996	Typically exceeds 100 kPa at 10% compression
Water Vapour Resistance	BS EN 12086:1997 / I.S. EN 12086:1998	> 100 MN-s/g For the purpose of calculation of condensation risk, the resistivity of the plasterboard component of the product should be taken as 50 MN-s/g-m.

Fire Performance

Test	Test Method	Result
Ignitability, Flame spread Heat release, Smoke release	AS 1530.3	0/0/0/0-1*
Group Classification	AS/NZS 3837	Group 1*
Surface Spread of Flame	BS 476 (Parts 6 & 7)	Class 0

* Applies only to the Kingspan Kooltherm® K10 insulation board used in the manufacture of this composite insulated plasterboard product.

Durability

If correctly applied, *Kingspan Kooltherm*[®] products can be expected to have a long life of service.

Their durability depends on the supporting structure and the conditions of its use.

Kingspan Kooltherm[®] products are warranted for a period of 10 years for both residential and commercial installations.*

** Subject to the terms of the complete Kingspan Kooltherm[®] warranty document which is available upon request or downloadable from www.kingspaninsulation.com.au.*

Limitations

Kingspan Kooltherm[®] K18 Insulated Plasterboard has a gypsum plasterboard face. It should, therefore, not be used to isolate dampness nor be used in continuously damp or humid conditions.

Environmental Data

Aspect	Characteristic
Recycled/Renewable Content	1.3%
Recyclability	Non-contaminated insulation site waste is recyclable, but there are currently no facilities in Australia to process returned material
Re-usability	Re-usable if removed with care (long term of service expected)
Water Use	No water used in Kingspan Insulation's manufacturing process
Blowing Agent Global Warming Potential (GWP)	Manufactured with a blowing agent that has low GWP
Blowing Agent Ozone Depletion Potential (ODP)	Manufactured with a CFC/HCFC-free blowing agent that has zero ODP
Packaging	Contains 0% recycled product Polythene wrap and EPS skids 100% recyclable

Installation Instructions

Mechanical Fixing to Timber Joists or Rafters

Kingspan Kooltherm[®] K18 Insulated Plasterboard may be used to line ceilings or infill where an exposed rafter is desired. Installation is similar to that of standard plasterboard.

1. A minimum of 20 mm bearing onto the timbers must be offered at each sheet joint.
2. Sheets should be fixed using either drywall screws or suitable galvanised plasterboard nails located at 150 mm centres.
3. Ensure fixings are located no less than 10 mm from the edges of the sheet.
4. Fixings should be long enough to allow a minimum embedment of 20 mm into the timber.
5. Fixings should be driven straight with the heads embedded just below the surface of the sheet. Care should be taken not to overdrive the fixing.

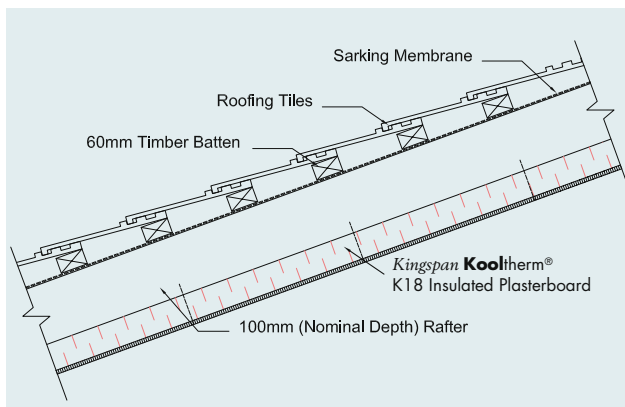

Figure 3 Side elevation - Raked ceiling with *Kingspan Kooltherm*[®] K18 Insulated Plasterboard

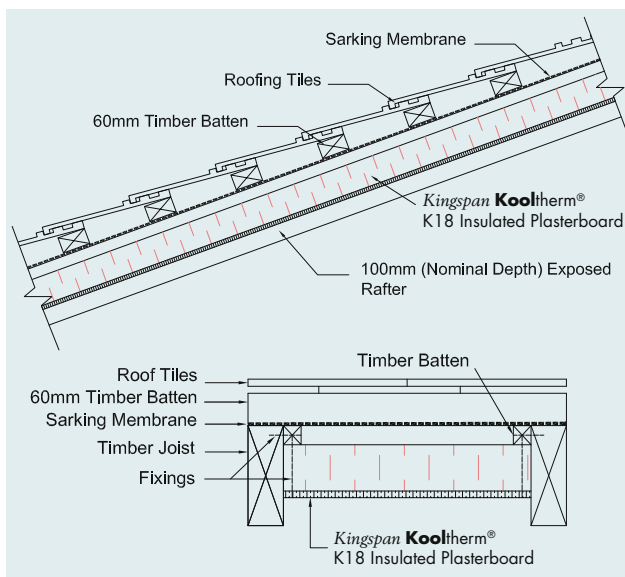

Figure 4 Side and front elevation - Raked ceiling (exposed beam) with *Kingspan Kooltherm*[®] K18 Insulated Plasterboard

General Requirements

Cutting

Cutting should be carried out either by using a fine toothed saw, or by scoring with a sharp knife through the insulation and scoring the back of the plasterboard itself, then snapping the board over a straight edge and then cutting the facing on the other side. Ensure accurate trimming to achieve close-butting joints and continuity of insulation.

Packaging

According to quantity, the boards are supplied in packs, labelled and shrink-wrapped in polythene.

Handling and Storage

Storage

The packaging of *Kingspan Kooltherm*[®] should not be considered adequate for long term outdoor protection. Ideally boards should be stored inside a building. If, however, outdoor storage cannot be avoided then the boards should be stacked clear of the ground and covered with an opaque polythene sheet or weatherproof tarpaulin. Boards that have been allowed to get wet should not be used.

Resistance to Solvents

The insulation core is resistant to short-term contact with petrol and with most dilute acids, alkalis and mineral oils. However, it is recommended that any spills be cleaned off fully before the boards are installed. Ensure that safe methods of cleaning are used, as recommended by suppliers of the spill liquid. The insulation core is not resistant to some solvent-based adhesive systems, particularly those containing methyl ethyl ketone. Adhesives containing such solvents should not be used in association with this product. Damaged boards or boards that have been in contact with harsh solvents or acids should not be used.

OH & S

Kingspan Insulation products are chemically inert and safe to use. A Product Safety Information sheet is available from *Kingspan* Insulation Pty Ltd.

Please note that the reflective surfaces on this product are designed to enhance their thermal performance. As such, they will reflect light as well as heat, including ultraviolet light. Therefore, if these boards are being installed during bright or sunny weather, it is advisable to wear UV protective sunglasses or goggles and if the skin is exposed for a significant period of time, to protect bare skin with a UV block sun cream.

Contact Details

General Enquiries

Tel: +61 (7) 3636 6800

Email: info.nz@insulation.kingspan.com

Kingspan Insulation Pty. Ltd. reserves the right to amend product specifications without prior notice. The information, technical details and fixing instructions etc. included in this literature are given in good faith and apply to uses described. Recommendations for use should be verified as to the suitability and compliance with actual requirements, specifications and any applicable laws and regulations. For other applications or conditions of use, Kingspan Insulation offers a Technical Advisory Service the advice of which should be sought for uses of Kingspan Insulation products that are not specifically described herein. Please check that your copy of the literature is current by contacting us or visiting www.kingspaninsulation.co.nz



Kingspan Insulation Pty Ltd

Tel: +61 (7) 3636 6800

Email: info.nz@insulation.kingspan.com

www.kingspaninsulation.co.nz